

NOTES:  
 1) UNDER NO CIRCUMSTANCES SHOULD DIMENSIONS BE SCALED FROM THIS DRAWING "IF IN DOUBT ASK"  
 2) THIS DRAWING IS TO BE READ IN CONJUNCTION WITH ALL OTHER RELEVANT DRAWINGS. ANY DISCREPANCIES, ERRORS OR OMISSIONS TO BE BROUGHT TO THE ATTENTION OF TAYLOR YOUNG.  
 3) ALL DIMENSIONS TO BE CHECKED BEFORE COMMENCEMENT  
 4) THIS DRAWING IS THE PROPERTY OF TAYLOR YOUNG AND MUST NOT BE COPIED OR REPRODUCED EITHER IN WHOLE OR IN PART WITHOUT WRITTEN PERMISSION

drawing originated by: CH date: 08/11/09  
 revisors: draw: date:  
 REV: \_ \_ \_

CHESHIRE BOROUGH COUNCIL  
 TOWN AND COUNTRY PLANNING

08 APR 2011

THIS IS THE PLAN REFERRED TO IN  
 APPLICATION No. 0252

The Legacy Rainbow House -  
 Landscape and Visual Impact  
 Assessment

Indicative Masterplan

Scale: 1:1250 @ A3  
 Reviewed by: CA

Job drawing rev  
 4499 SH\_GA\_90\_001

taylor young ty

chadsworth house  
 wilmslow road  
 handforth  
 cheshire  
 sk9 3hp

tel: 01625 542 200  
 fax: 01625 542 250  
 mail@tayloryoung.co.uk  
 www.tayloryoung.co.uk



architecture  
 graphics  
 healthcare planning  
 interior design  
 landscape architecture  
 regeneration  
 town planning  
 urban design  
 3D visualisation

© Crown Copyright. All rights reserved. LIG0358.2009

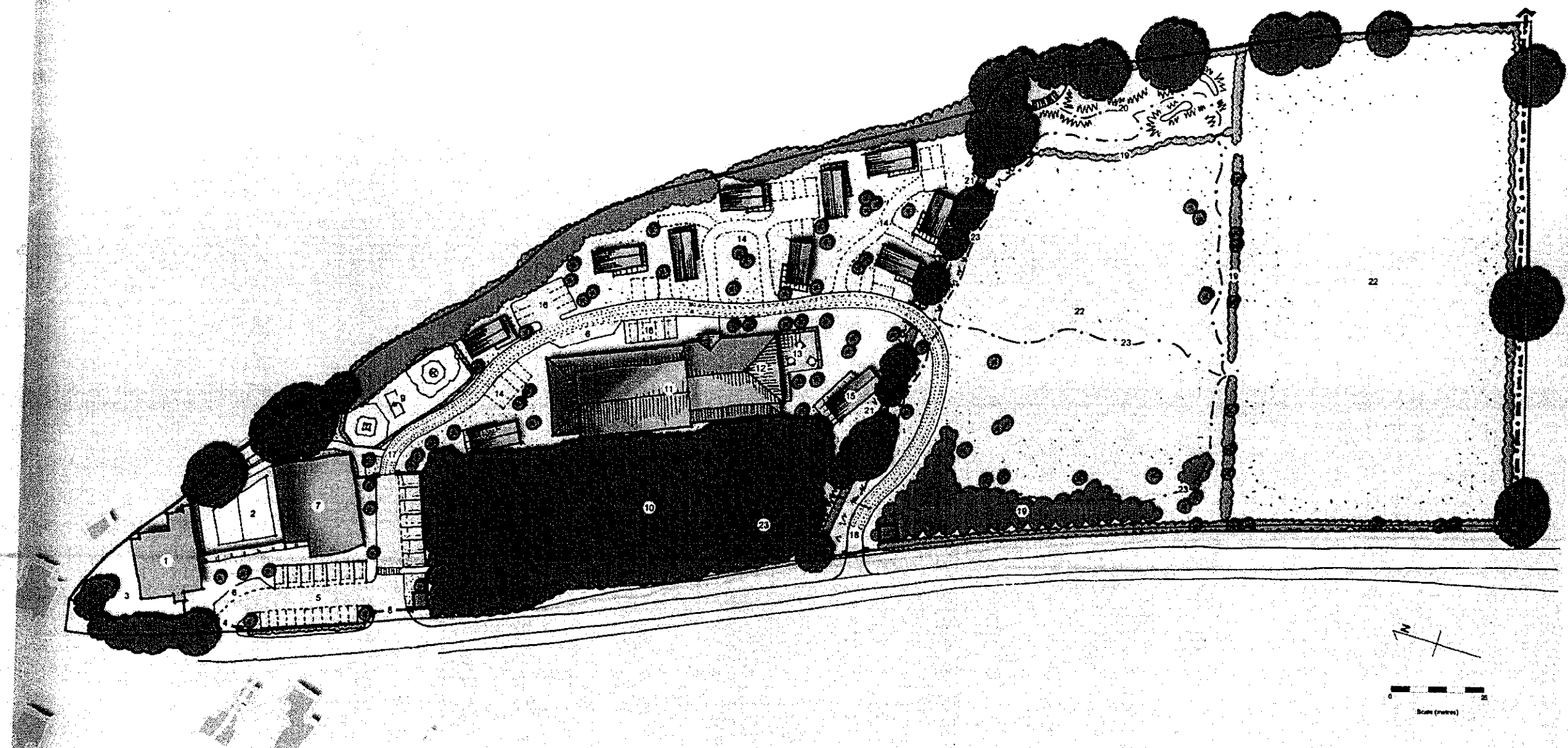

Key:  Redline Application Boundary

- |   |   |   |   |   |
|---|---|---|---|---|
| 1 Existing building   | 7 Acquired Brain Injury Unit (with connecting covered walkway to existing building) | 12 Hydrotherapy Pool                                      | 16 Staff parking  | 21 Enhancement of existing ditch to encourage Water Voles                   |
| 2 Existing outdoor play area                                    | 8 New exit to parking area  | 13 Outdoor seating area associated with Hydrotherapy Pool | 17 Access track to Sports Therapy Rehabilitation Unit (no through access) | 22 Wildflower meadows   |
| 3 Existing garden   | 9 Wheelchair-friendly Adventure Playground  | 14 Disability-friendly Accommodation Lodges               | 18 Access track to majority of lodges (no through access)                 | 23 Wildlife trails  |
| 4 Main access retained  | 10 Existing woodland retained and improved  | 15 Night Staff Accommodation Lodge                        | 19 Extension of existing woodland and new hedge planting                  | 24 Existing Public Right of Way separated from rest of site by new hedgerow |
| 5 Reconfigured and extended parking area for staff and visitors | 11 Sports Therapy Rehabilitation Unit   | 16 Staff parking  | 20 Wetland habitat area   |   |